

BAKER FIRST  
COMMERCIAL REAL ESTATE



RESPONSIVE



RELIABLE



RESULTS

BROKERAGE - DEVELOPMENT -  
CONSTRUCTION - PROPERTY MANAGEMENT

## 6510 S. WESTERN OKLAHOMA CITY, OK

FOR SALE: \$150,000

FOR MORE INFORMATION CONTACT:

**BEN SCHMIDT, CCIM**  
P. 405.947.7200  
C. 405.550.5251  
E. SCHMIDTB@BAKERFIRST.COM  
W. WWW.BAKERFIRST.COM

PROPERTY INFORMATION:

USE: LAND  
TERMS: SALE  
TOTAL LAND IN ACRES: 0.2952MOL  
TOTAL SF: 12,858.912MOL  
VISIBILITY: GOOD

PROPERTY HIGHLIGHTS:

- 0.29 ACRES MOL OF MEDICAL OFFICE LAND FOR SALE
- ZONED 0-2, OFFICE USE
- GREAT LOCATION FOR A MEDICAL OFFICE TO BE PART OF THE WESTERN MEDICAL PARK
- CLOSE TO INTEGRIS SOUTHWEST MEDICAL CENTER
- EASY ACCESS TO I-240

DEMOGRAPHICS (CCIM): 2008

RADIUS:	POPULATION	HOUSEHOLD INCOME:
1	6,579	\$29,532
3	51,319	\$32,246
5	99,950	\$34,437

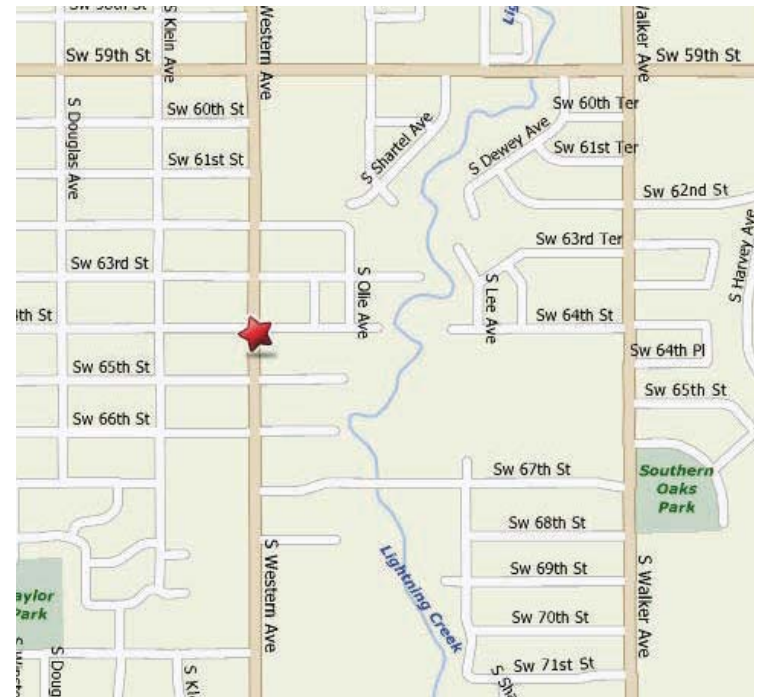

## DOWNTOWN OKLAHOMA CITY, OK



### 20 LARGEST AREA EMPLOYERS:

1. STATE OF OKLAHOMA:	38,000
2. TINKER AIR FORCE BASE:	27,000
3. US POSTAL SERVICE:	8,700
4. INTEGRIS HEALTH:	7,000
5. OKLA. CITY PUBLIC SCHOOLS:	5,900
6. FAA AERONAUTICAL CENTER:	5,600
7. CHESAPEAKE ENERGY:	4,900
8. DEVON ENERGY:	4,600
9. CITY OF OKLA. CITY:	4,700
10. AT&T:	4,600
11. OU HEALTH SERVICES CENTER:	4,200
12. OU MEDICAL CENTER:	3,250
13. OGE ENERGY:	3,132
14. MERCY HEALTH:	2,750
15. HOBBY LOBBY STORES:	2,522
16. UPS:	2,300
17. DELL:	2,100
18. COX COMMUNICATIONS:	2,000
19. DEACONESS HOSPITAL:	1,900
20. OKLAHOMA COUNTY:	1,800

\*THIS LIST WAS COMPILED BY THE ECONOMIC DEVELOPMENT DIVISION OF THE GREATER OKLAHOMA CITY CHAMBER FROM A VARIETY OF SOURCES.

